

N=1045.000  
N=1040.000  
N=1035.000  
N=1030.000  
N=1025.000  
N=1020.000  
N=1015.000  
N=1010.000  
N=1005.000  
N=1000.000  
N=995.000  
N=990.000  
N=985.000  
N=980.000  
N=975.000  
N=970.000  
N=965.000  
N=960.000  
N=955.000  
N=950.000  
N=945.000

E=965.000  
E=970.000  
E=975.000  
E=980.000  
E=985.000  
E=990.000  
E=995.000  
E=1000.000  
E=1005.000  
E=1010.000  
E=1015.000  
E=1020.000  
E=1025.000  
E=1030.000  
E=1035.000  
E=1040.000  
E=1045.000

STN POINT 4  
N=969.792  
E=978.706  
Z=52.467

STN POINT 5  
N=955.819  
E=1010.222  
Z=54.223

TBM on the ramp  
RL=52.731

TBM on the ramp  
RL=52.703

STN POINT 2  
N=1004.682  
E=1031.797  
Z=52.703

- Notes:
1. All dimensions are in m.
  2. TBM 50.0m assumed at Survey Station No.1. All Levels are related.
  3. Contour interval is 0.50m.
  4. Grid RL @ 2.5m interval is provided.

ORIENTATION

Total area surveyed = 2476.00sq. m s

**LEGEND:**

- ROAD
- BOUNDARY
- COMPOUND WALL
- BOUNDARY PILLAR
- BUILDING
- TOILET
- SHED
- FOOT PATH
- RAMP
- RETAINING WALL
- DRAIN
- WELL
- GATE
- ELECTRIC POLE
- STN POINT
- SURVEY LINE
- TBM
- RL
- RL AT GRID INTERSECTION
- CONTOUR LINE
- COCONUT TREE
- PIPAL TREE
- MANGO TREE
- JUNGLI TREE
- TREE
- WATER TANK

Sl. NO.	DATE	DESCRIPTION
REVISION		
DRAWING NO. - GL/16-17/12	SHEET NO.	
REVISION NO. 0	1/1	
ISSUE DATE - APR2016	SCALE - 1:250	

**ANANDA MARGA SCHOOL**  
JUNGLIGHAT PORT BLAIR,

PROJECT:  
SURVEY SITE PLAN OF ANANDA MARGA SCHOOL COMPLEX AT JUNGLIGHAT.

DRAWING TITLE:  
SURVEY SITE PLAN WITH LEVEL

DEALT BY:

**GLOBE CONSULTANCIES**  
Chief Engineering Consultant  
Rajiv Gandhi Nagar, Near ANIDCO Office,  
Port Blair, Andaman Islands  
Tels: Fax: 03192-237907, Mobile: 9434280874  
Email: gbl@anm@gmail.com

CONSULTANT

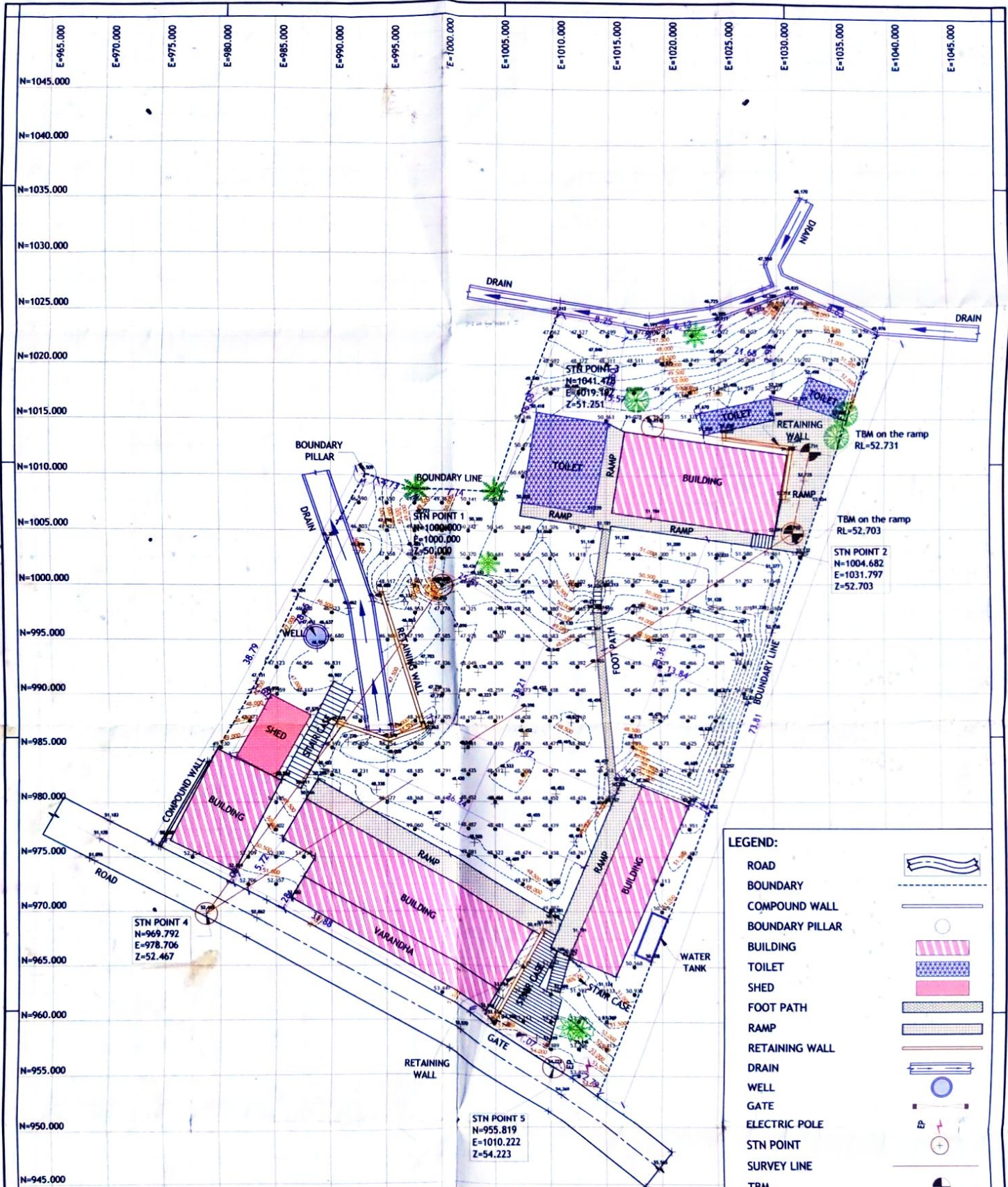

- Notes:
1. All dimensions are in m.
  2. TBM 50.0m assumed at Survey Station No.1. All Levels are related.
  3. Contour interval is 0.50m.
  4. Grid RL @ 2.5m interval is provided.

ORIENTATION

Total area surveyed = 2476.00Sq.m s

- LEGEND:
- ROAD
  - BOUNDARY
  - COMPOUND WALL
  - BOUNDARY PILLAR
  - BUILDING
  - TOILET
  - SHED
  - FOOT PATH
  - RAMP
  - RETAINING WALL
  - DRAIN
  - WELL
  - GATE
  - ELECTRIC POLE
  - STN POINT
  - SURVEY LINE
  - TBM
  - RL AT GRID INTERSECTION
  - CONTOUR LINE
  - COCONUT TREE
  - PIPAL TREE
  - MANGO TREE
  - JUNGLI TREE
  - TREE
  - WATER TANK

SL NO.	DATE	DESCRIPTION
REVISION		
DRAWING NO. - GL/16-17/12		SHEET NO.
REVISION NO. 0		1/1
ISSUE DATE - APR2016		SCALE - 1:250

**ANANDA MARGA SCHOOL**  
JUNGLIGHTAT PORT BLAIR.

PROJECT:  
SURVEY SITE PLAN OF ANANDA MARGA SCHOOL COMPLEX AT JUNGLIGHTAT.

DRAWING TITLE:  
SURVEY SITE PLAN WITH LEVEL

DEALT BY:

**GLOBE CONSULTANCIES**  
Chief Engineering Consultants  
Rajiv Gandhi Nagar, Near ANIDCO Office,  
Port Blair, Andaman Islands.  
Tele/Fax: 03592 - 237967, Mobile:9434280874.  
Email: gpc@anmv@gmail.com

CONSULTANT